

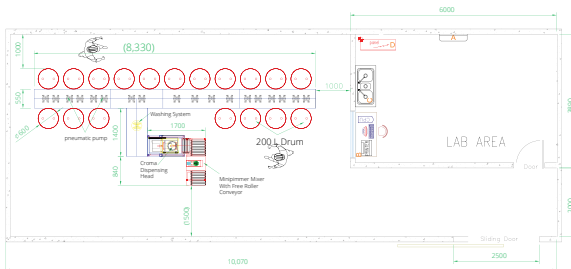

CROMA WATER BASED



TECHNICAL DATA

Components	Up to 18
Valves' Diameter	DN14
Dispensing Accuracy	1 g
Average Dispensing Time	3-4 min for a 20 Kg batch



Conceptual Layout
For illustration purpose only.
Actual layout might differ.



EEX (ATEX or IEC-EX)

CROMA

The Inkmaker CROMA is an automatic dispensing system, conceived to offer an affordable solution for users with moderate output requirements.

Fully automatic and easy to operate, it requires minimal input

The operator can produce the required formulas in few **simple steps and with perfect accuracy**

The CROMA can accommodate a **maximum of 18 x DN14, high precision, multi stage dispensing valves**

Valves are placed in a circle; the minimum required Ø of the dispensing container is 280 mm

The number of valves mounted on each equipment is be **based on actual customer's requirements**

The CROMA can handle both **water based as well as solvent-based products (Ex - ATEX or IEC-EX - version)**

Extremely compact and with a very limited footprint

The system management and automation are run by **Inkmaker software**

Scale tare **is automatically set by the computer**

A weigh summary sheet is printed for each batch **showing the exact batch information**

The user **can display or print Aseveral reports**, including: dispensed formulas, job costing, production history, stock availability, etc.

Production traceability is simplified with the use of a bar-code system c/w bar-code reader and bar-code label printer

Pneumatic pumps **deliver the base components to the dispensing head**

Components can be stocked in 200 L drums or in other type of containers of different size and capacity

ADVANTAGES

Extremely easy to operate with user friendly interface which can be linked with the most common ERP and MRP programmes

Easy interface with any brand of spectrophotometer

Consistent formula reproduction insuring correct product repeatability

Production of the right quantity whenever needed

Dispensing parameter self-adjustment ensures optimal accuracy

Major stock reduction and rationalisation

Seamless stock management with stock information, graphic components' stock display, stock auditing and batch cost evaluation

Optimized recycle-management

Elimination of wastage

Complete tracking of operation and ISO compliance traceability

Password protected formula database and automatic back-up to prevent data loss

Reports on production statistics with over 100 reports for KPI assessment

Production planning

Easy maintenance

Increased free space in the factory

Improved workplace cleanliness, tidiness and safety